

Park Hall

HOTEL & SPA



CONFERENCES

CONTENTS

THE VENUE	4
EDNAM ROOM	5 - 6
SEDGLEY ROOM	7 - 8
PARK & DUDLEY SUITE	9 - 10
THE ORANGERY	11 - 12
THE BALLROOM	13 - 14
DELEGATE RATES	15



The Ramada Park Hall Hotel & Spa is a 4 star grade II listed Georgian hotel set in five acres of landscaped gardens. Set in the heart of the West Midlands the hotel is conveniently located close to major motorway links around the region.

Offering you a choice of six conference and meeting rooms, 73 bedrooms, two quality restaurants, beautiful gardens and an exclusive health club and spa we are the first choice for your next conference or meeting in the West Midlands.

With conference and meeting facilities available for up to 550 delegates we can offer you room hire, day delegate or a 24 hour delegate basis along with complimentary Wi-Fi and car parking.

Our conference team will assist you in making sure that your next meeting or conference is planned and delivered perfectly.

Call 01902 349549 to speak with our Conference Team who will be able to discuss your individual requirements.

EDNAM ROOM

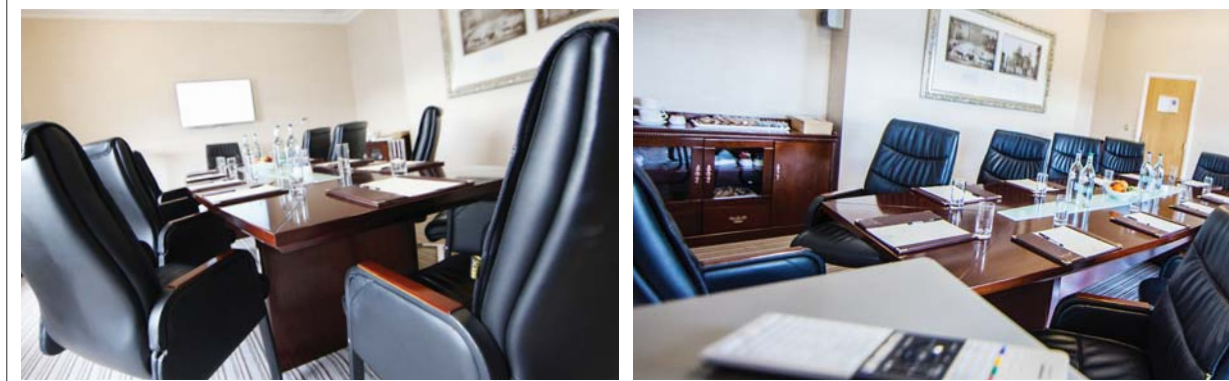

The Ednam is an executive, period style room which can accommodate up to ten seated people.

The room has a traditional yet contemporary feel, enhanced by tasteful décor, beautiful large Georgian windows, original artwork and leather executive seating.

Located on the first floor, the Ednam Room is a quiet and discrete room which can be used for formal boardroom style meetings.

AT A GLANCE:

- Number of Guests: 10
- Room Dimensions:
L 5.5m x W 4.5m x H 3m
- Air Conditioning
- Natural light
- No Wheelchair Access

Ednam Room Specifications

Location	1st Floor
Cabaret	-
Theatre	-
Classroom	-
Boardroom	10
U Shape	-
Private Dining	10
Length (metres)	5.5
Length (feet)	18
Width (metres)	4.5
Width (feet)	15
Height (metres)	3
Height (feet)	10
Wheelchair Access	NO
Natural Daylight	YES
Air Conditioning	YES
Telephone Points	YES



- TV** TV
- H** HDMI POINT
- V** VGA POINT
- AC** AIR CON CONTROL
- PP** POWER POINT
- F** FIRE EXIT
- T** TELEPHONE

SEDGLEY ROOM



The larger of our boardroom style meeting rooms, The Sedgley Room can accommodate up to 50 seated people. This room offers a significant and inspiring setting for hosting various business and board meetings whilst being airy and modern, with plenty of natural light.

The Sedgley Room is the perfect option to host business meetings, training events and corporate private dining through to family celebrations and dinners.

AT A GLANCE:

- Number of Guests: 50
- Room Dimensions:
L 11m x W 4m x H 2.5m
- Air Conditioning
- Natural light
- No Wheelchair Access

Sedgley Room Specifications

Location	1st Floor
Cabaret	35
Theatre	45
Classroom	20
Boardroom	25
U Shape	22
Private Dining	50
Length (metres)	11
Length (feet)	36
Width (metres)	4
Width (feet)	14
Height (metres)	2.5
Height (feet)	8.5
Wheelchair Access	NO
Natural Daylight	YES
Air Conditioning	YES
Telephone Points	YES

- TV** TV
- H** HDMI POINT
- V** VGA POINT
- AC** AIR CON CONTROL
- D** DATA POINT
- PP** POWER POINT
- F** FIRE EXIT
- T** TELEPHONE

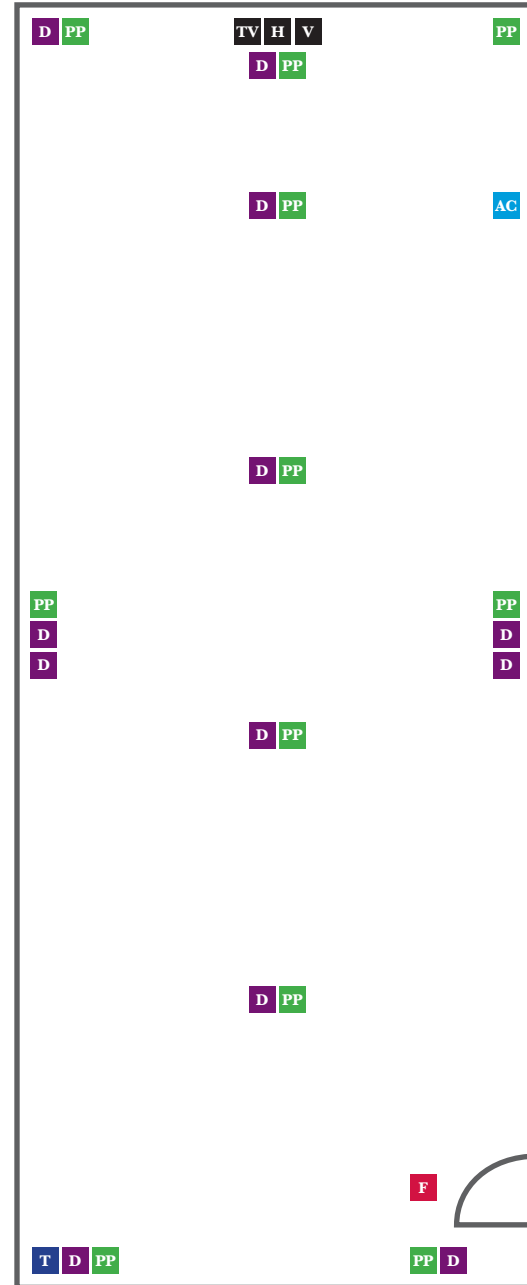

PARK & DUDLEY SUITE



The bespoke fixtures, fittings and marble flooring in the Park and Dudley Suite provide an elegant yet welcoming feel to this multi-functional, flexible meeting space.

The Park and Dudley Suite can be divided into two distinct meeting areas. The Park Suite offers the central meeting space, with a capacity to seat up to 65 delegates in a theatre style, which can be expanded by integrating with the adjacent Dudley Suite.

Alternatively the retractable room divider can be used to provide a refreshment area, break out space or used for team building and other business activities.

AT A GLANCE:

- Number of Guests: 120
- Room Dimensions:
L 19.5m x W 8.5m x H 3m
- Air Conditioning
- Natural light
- Wheelchair Access

Park & Dudley Suite Specifications

	Park Suite	Dudley Suite	Park & Dudley
Location	Ground	Ground	Ground
Cabaret	42	40	90
Theatre	65	50	100
Classroom	30	20	40
Boardroom	26	28	50
U Shape	36	20	30
Private Dining	60	60	120
Length (metres)	9.5	10	19.5
Length (feet)	31	33.5	64
Width (metres)	8.5	8.5	8.5
Width (feet)	28	28	28
Height (metres)	3	3	3
Height (feet)	10	10	10
Wheelchair Access	YES	YES	YES
Natural Daylight	YES	YES	YES
Air Conditioning	YES	YES	YES

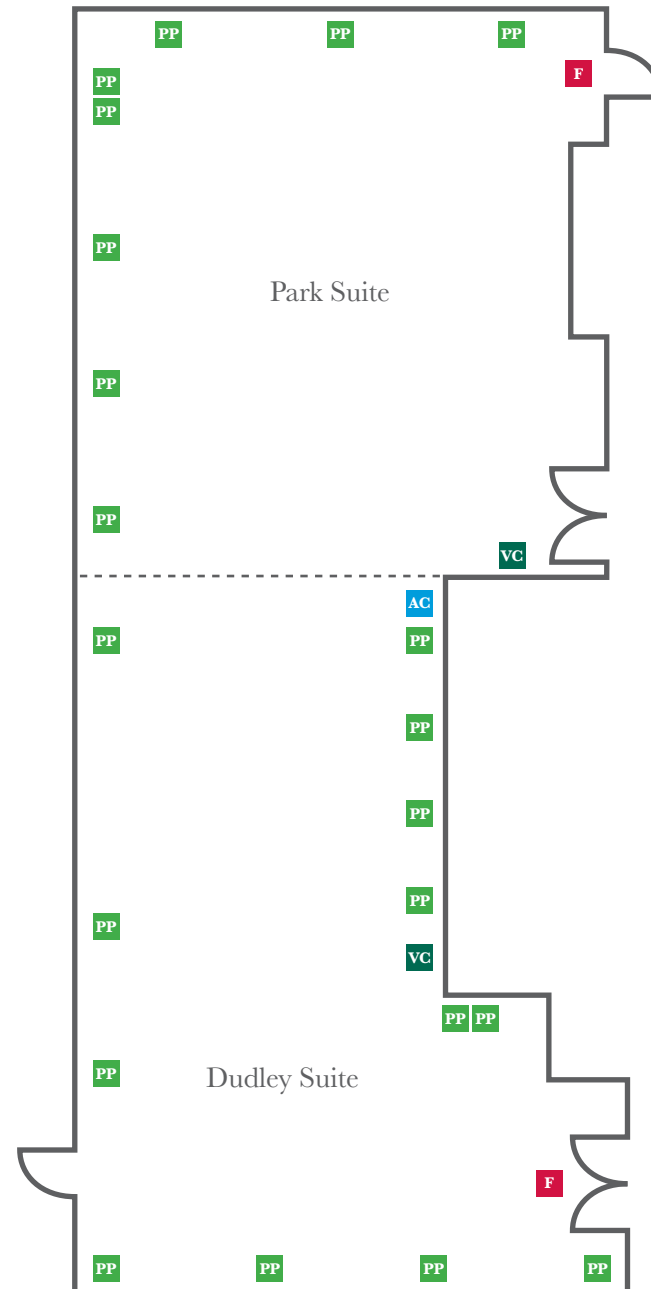

- TV POWER POINT
- VC VOLUME CONTROL
- AC AIR CON CONTROL
- PP FIRE EXIT

THE ORANGERY



The Orangery is a split-level function room and is the most recent addition to our conference facilities.

The upper Orangery offers a flexible meeting space that can be adapted to meet your specific conference requirements. With capacity for up to 80 delegates this room is light, airy and diverse enough to suit any meeting layout or style.

The lower Orangery presents the perfect breakout area to serve your delegates morning breakfast and/or lunchtime refreshments during the day.

AT A GLANCE:

- Number of Guests: 80
- Room Dimensions:
L 11m x W 8.5m x H 2.5m
- Air Conditioning
- Natural light
- Wheelchair Access

The Orangery Specifications

	Upper Level	Lower Level
Location	Ground	Ground
Cabaret	42	-
Theatre	70	-
Classroom	26	-
Boardroom	28	-
U Shape	32	-
Private Dining	80	-
Length (metres)	11	9.5
Length (feet)	36.5	31.5
Width (metres)	8.5	7
Width (feet)	28.5	23
Height (metres)	2.5	4
Height (feet)	9.5	13
Wheelchair Access	YES	YES
Natural Daylight	YES	YES
Air Conditioning	YES	YES

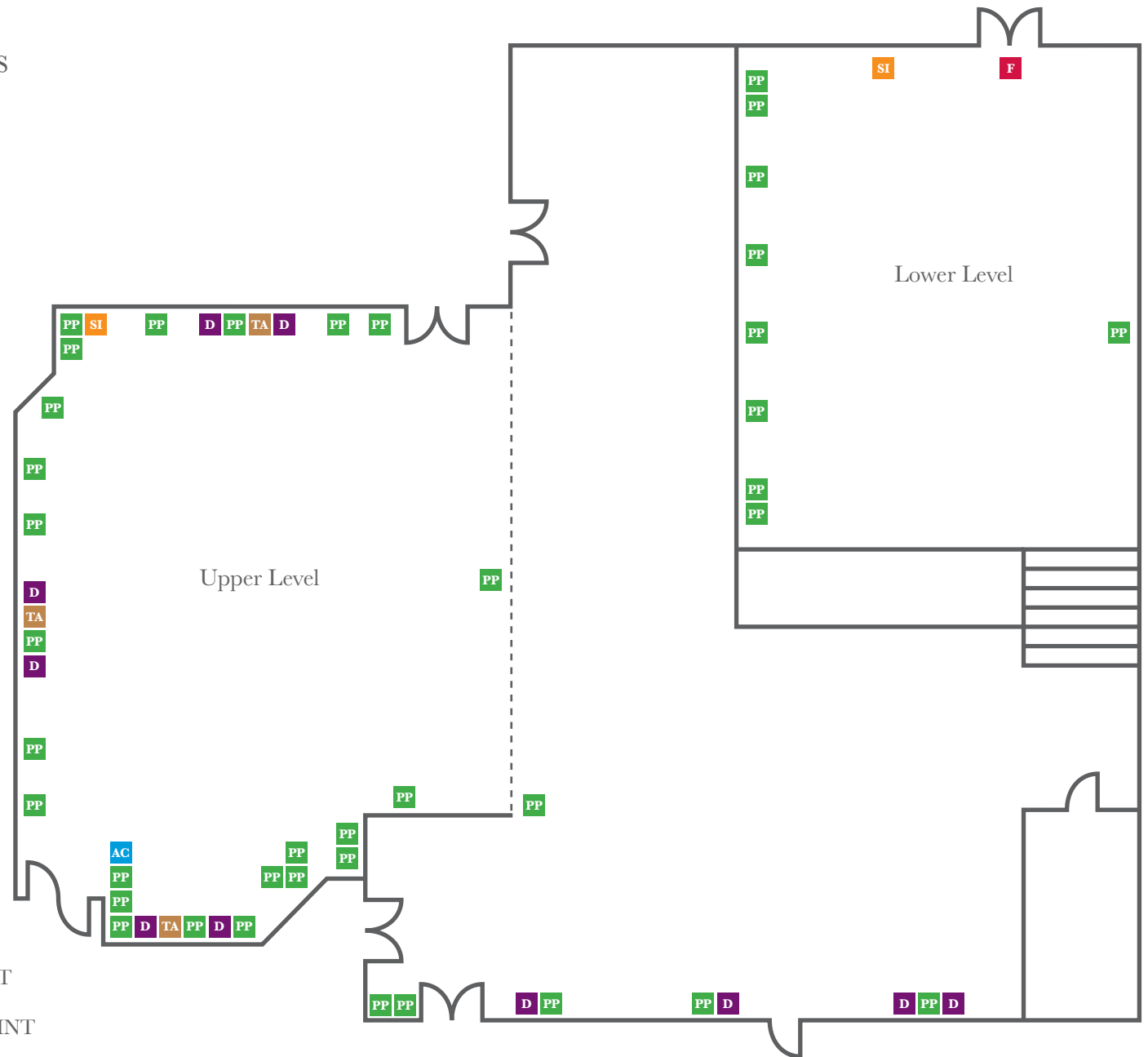

- TA TV ARIEL
- PP DATA POINT
- SI SOUND INPUT
- PP POWER POINT
- AC AIR CON CONTROL
- F FIRE EXIT

THE BALLROOM



The Ballroom, our largest conference room is infused in natural lighting, with floor to ceiling Georgian windows and panoramic views to the formal gardens and Staffordshire countryside and beyond.

Providing seating for up to 550 delegates, The Ballroom also has an adjoining foyer which can be used as a breakout space or a refreshments area for your conference delegates.

The Ballroom is perfect for all types of business and social functions such as AGM's, conferences, exhibitions and gala dinners.

AT A GLANCE:

- Number of Guests: 550
- Room Dimensions:
L 26m x W 21.5m x H 4m
- Air Conditioning
- Natural light
- Wheelchair Access

The Ballroom Specifications

Location	Ground
Cabaret	225
Theatre	400
Classroom	300
Boardroom	200
U Shape	200
Private Dining	550
Length (metres)	26
Length (feet)	84.5
Width (metres)	21.5
Width (feet)	70.5
Height (metres)	4
Height (feet)	14
Wheelchair Access	YES
Natural Daylight	YES
Air Conditioning	YES

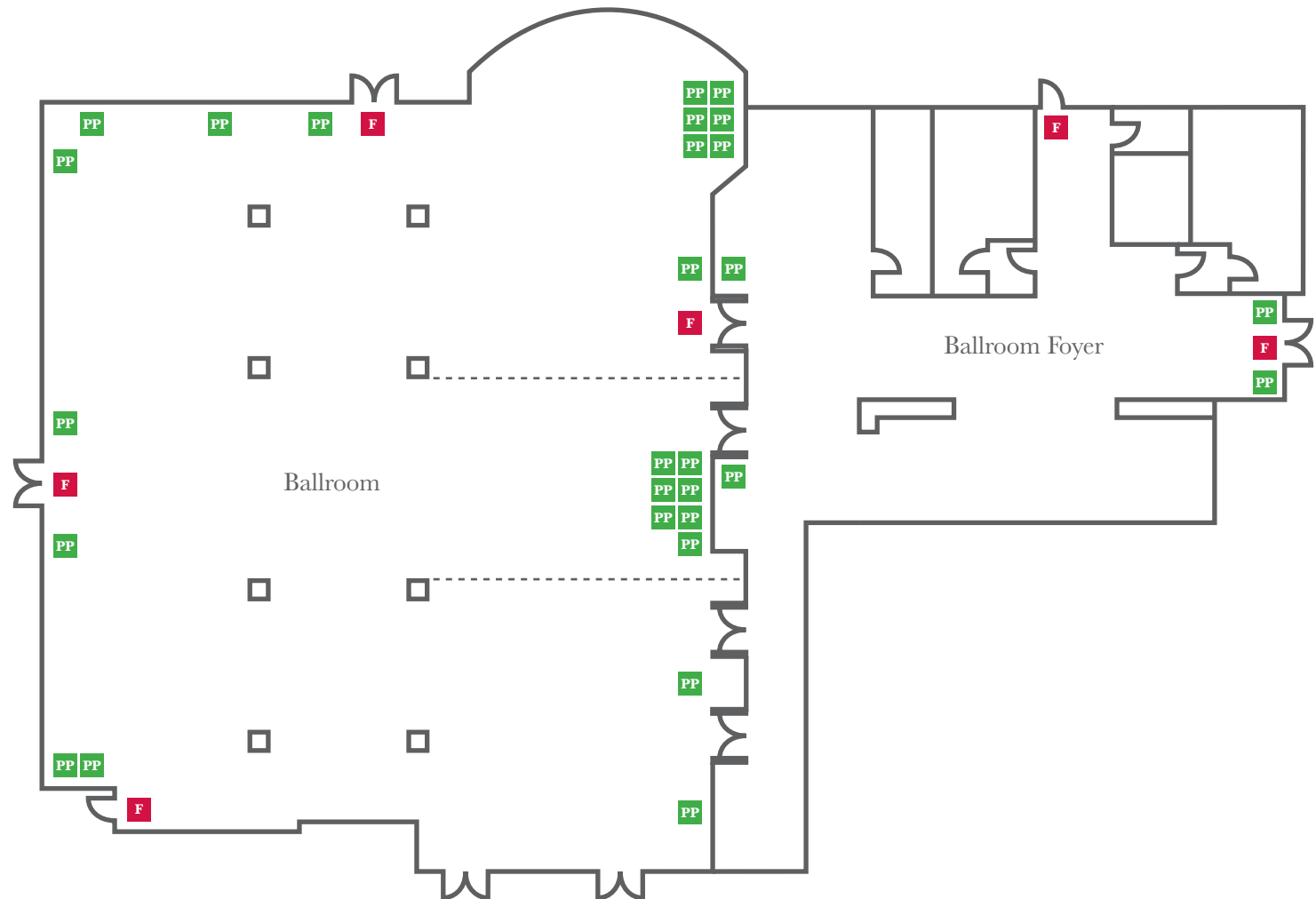

PP POWER POINT

F FIRE EXIT

DELEGATE RATES

Our standard conference packages include either a day delegate rate or a 24 hour inclusive rate. We will be happy to create a bespoke package should you have any specific requirements.

Please call the conference team on 01902 349549 to discuss further.

Day Delegate Rate includes:-

- On arrival, unlimited Tea and Coffee with Assorted Pastries
- Mid-Morning Tea and Coffee (with refills) and Biscuits
- 2 Course Buffet Lunch
- Afternoon Tea and Coffee (with refills) and Cakes
- Bottled Still and Sparkling Water
- Bowls of Wrapped Fruit Sweets
- Paper, Pens
- Screen, Flip Chart
- LCD Projector
- Wi-Fi
- Room Hire

24 hour Delegate Rate includes:-

- On arrival, unlimited Tea and Coffee with Assorted Pastries
- Mid-Morning Tea and Coffee (with refills) and Biscuits
- 2 Course Buffet Lunch
- Afternoon Tea and Coffee (with refills) and Cakes
- Bottled Still and Sparkling Water
- Bowls of Wrapped Fruit Sweets
- Paper, Pens
- Screen, Flip Chart
- LCD Projector
- Wi-Fi
- Room Hire
- Evening Dinner allocation (food only, excess payable by the delegate) to be used in our Restaurants
- Overnight Accommodation
- Full Breakfast Buffet on the morning of departure

Park Hall
HOTEL & SPA



Ramada Park Hall Hotel & Spa, Park Drive, Goldthorn Park, Wolverhampton WV4 5AJ
Tel: 01902 349549 Email: sales@ramadawolverhampton.com www.ramadawolverhampton.com